

archi
tec
ture
of ob
jects
26

BONALDO

BONALDO

26 Collection

Architecture of objects. La relazione tra materia e spazio costituisce l'essenza stessa dell'architettura: lo spazio viene definito dalla materia nel continuo alternarsi di luci e ombre. Una relazione capace di creare suggestioni sensoriali che vanno al di là della pura esperienza estetica; quando la luce e i materiali dialogano in modo armonico la natura degli spazi muta in modo immediatamente percettibile. In tal modo si ricrea la sensazione magica e sospesa delle atmosfere museali: l'oggetto artistico è tutt'uno con lo spazio che lo sottende. La relazione tra spazio e materia, la dialettica tra gli spazi e le forme sensibili, è il cuore della nostra ricerca. Ogni qualvolta un nostro prodotto ha la capacità di disegnare lo spazio in cui è inserito sino al punto di trasformarlo in atmosfera sensibile, è allora che la forma e la funzione hanno trovato la loro sintesi. Quando gli oggetti diventano architettura e gli ambienti trasmettono emozioni.

Architecture of objects. The relationship between matter and space lies at the very essence of architecture: space is defined by matter through the constant interplay between light and shadow. A relationship capable of evoking sensory experiences that go beyond mere aesthetics; when light and materials dialogue in harmony, the change in the nature of spaces is immediately apparent. In this way, a suspended, almost magical atmosphere, reminiscent of museum settings, is recreated: the artistic object becomes one with the space that surrounds it. The relationship between space and matter, the dialogue between spaces and tangible forms, is at the heart of our research. Whenever one of our products is able to shape the space in which it is placed, until it transforms it into a perceptible atmosphere, that is when form and function find their balance. When objects become architecture, and environments evoke emotions.

PAG 4-5*Tavoli / Tables***Flatiron table round top****Liaison****Oshi****PAG 22-23***Sedie / Chairs***Alpha****Artemis****Teia****PAG 36-37***Tavolini / Coffee Tables***Aspen****Gem****Sasso****Sloan****PAG 54-55***Credenze / Sideboards***Alicanto****Alicanto high****Blocco Sideboard****Spy****PAG 76-77***Porta TV / TV Stand***Arragan TV stand****PAG 76-77***Librerie / Bookshelves***Arragan shelf****PAG 80-81***Scrivani / Desks***Blocco Desk****Isabey desk****PAG 90-91***Specchi / Mirrors***Mistral****PAG 92-93***Divani / Sofas***Aldebaran****Belloalto****Grant****PAG 126-127***Poltrone / Armchairs***Amour****Ellison****PAG 138-139***Letti / Beds***Belloalto bed****Holden****PAG 152-153***Complementi notte /**Night Accessories***Isabey bedside table****PAG 156-157***Tappeti / Rugs***Amman****Lomé**



Tavoli / Tables

Flatiron table





Oshi





Oshi design Gabriele e Oscar Buratti



Liaison









Sedie / Chairs

Alpha







Teia



Artemis







Complementi / Accessories

Aspen







Sasso







Sloan

Gem





Blocco Sideboard







Alicanto







Alicanto high





Spy







Arragan shelf
Arragan TV stand





Blocco Desk





Blocco Desk design Alain Gilles



Isabey desk





Isabey desk design Gabriele e Oscar Buratti



Mistral



Mistral design Marconato & Zappa



Divani / Sofas

Aldebaran











Grant

















Belloalto









Poltrone / Armchairs

Amour



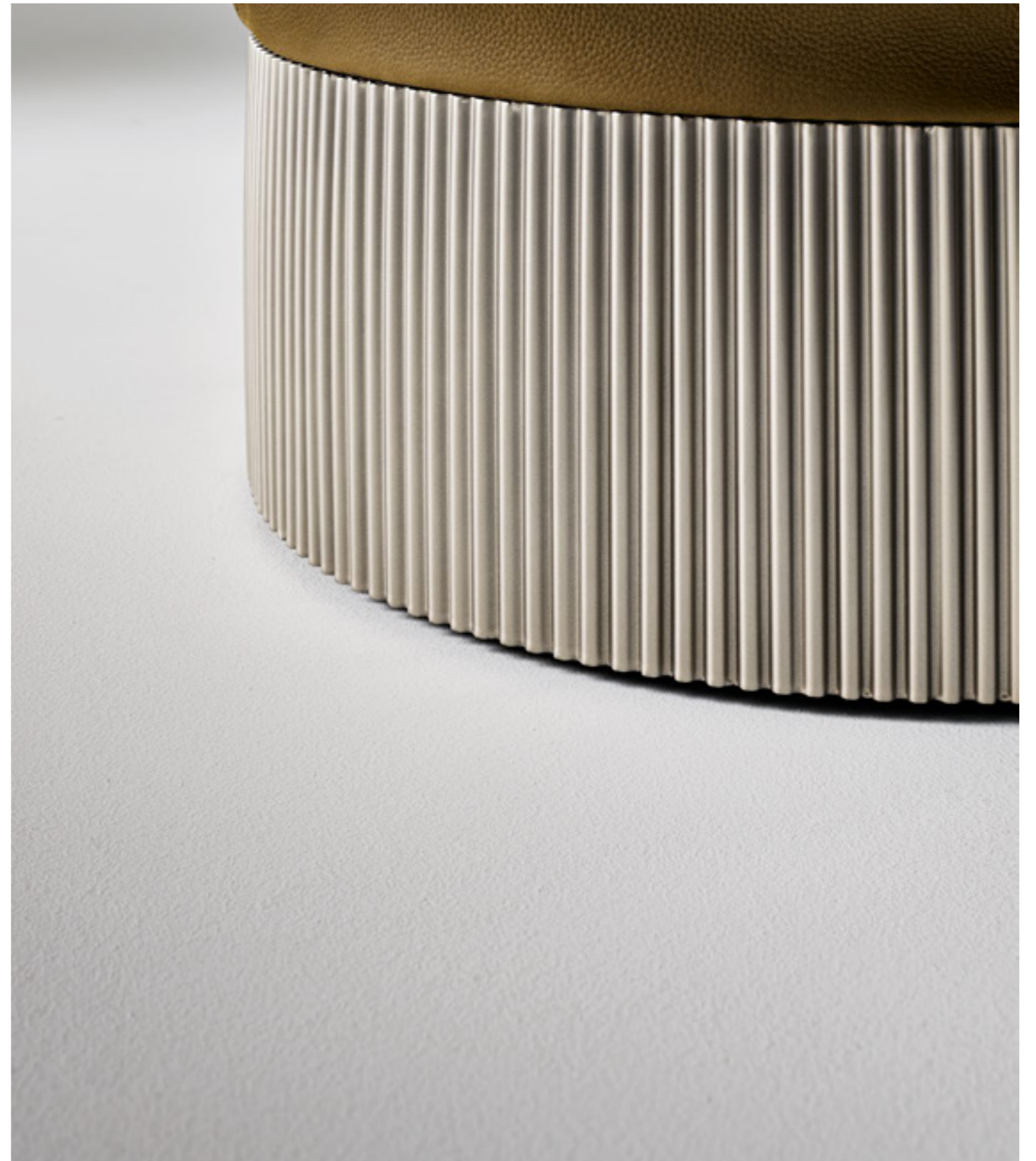



Ellison





Ellison design Massimo Castagna



Letti / Beds

Holden







Belloalto bed













Tappeti / Rugs

Amman

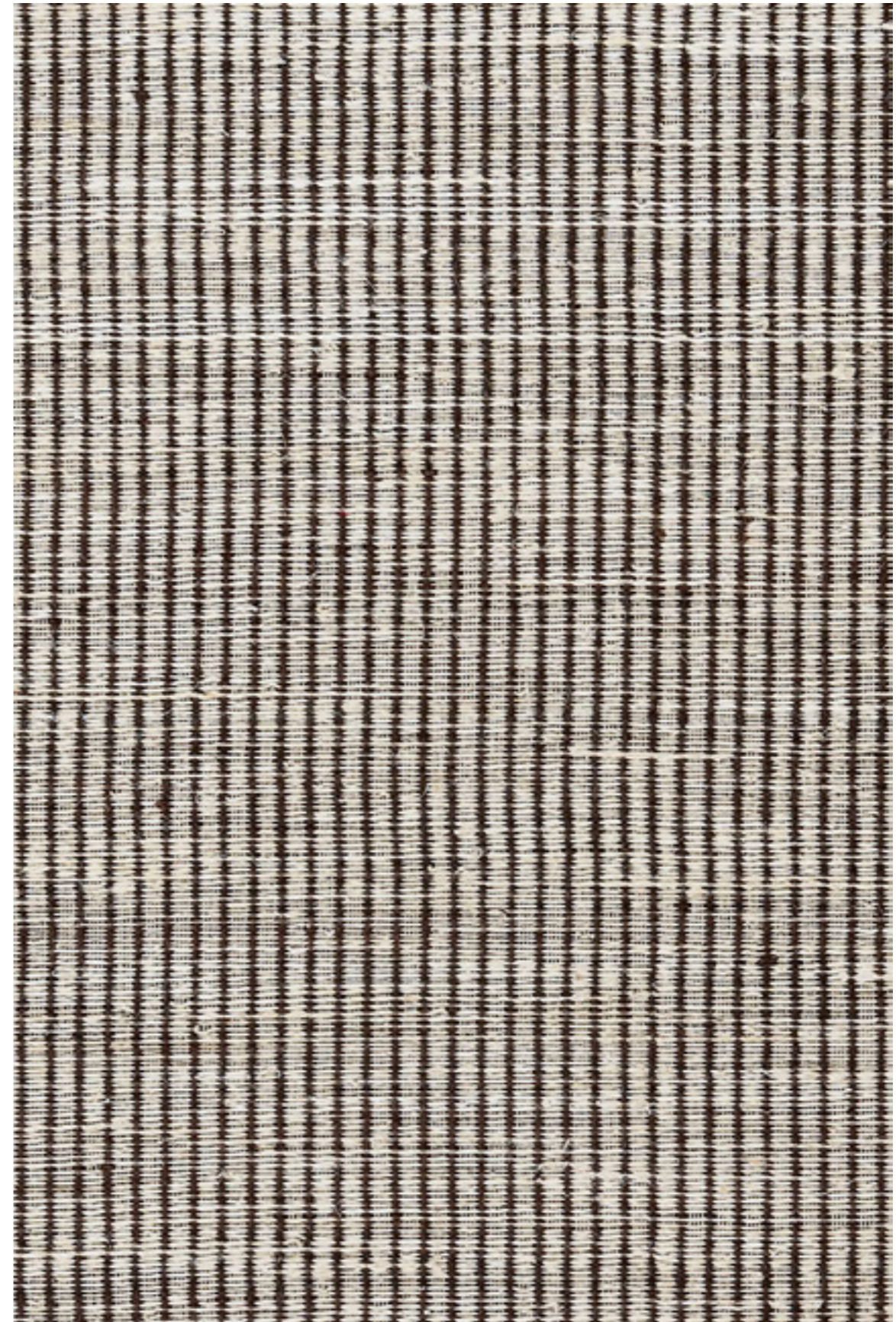

Lomé



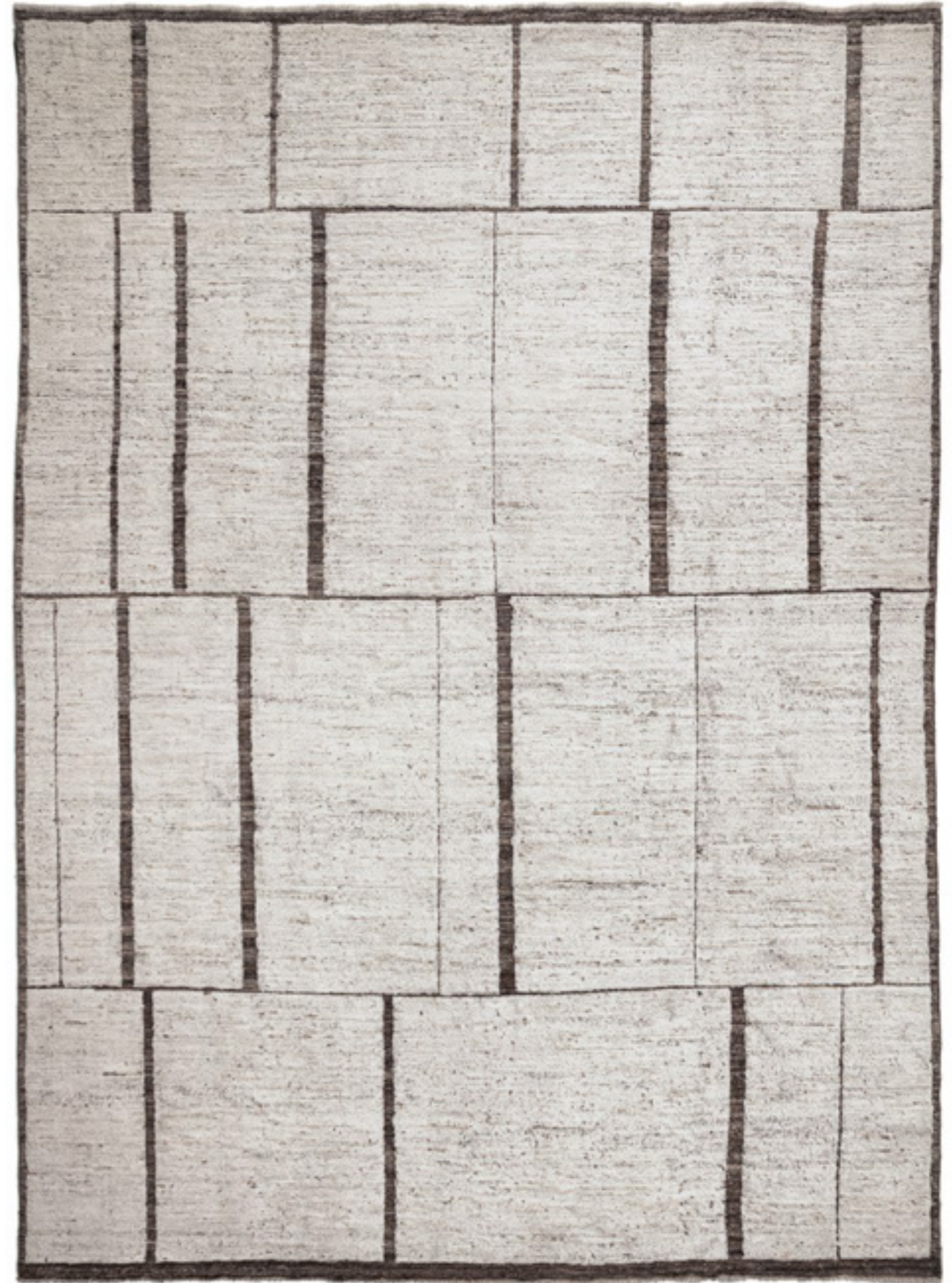

Informazioni tecniche / Technical details

PAG 166
Tavoli / Tables
Flatiron table
Liaison
Oshi

PAG 170
Sedie / Chairs
Alpha
Artemis
Teia

PAG 173
Tavolini / Coffee Tables
Aspen
Gem
Sasso
Sloan

PAG 177
Credenze / Sideboards
Alicanto
Alicanto high
Blocco Sideboard
Spy

PAG 181
Librerie / Bookshelves
Arragan shelf

PAG 182
Porta TV / TV Stand
Arragan TV stand

PAG 183
Scrittoi / Home office
Blocco Desk
Isabey desk

PAG 185
Specchi / Mirrors
Mistral

PAG 186
Divani / Sofas
Aldebaran
Belloalto
Grant

PAG 198
Poltrone / Armchairs
Amour
Ellison

PAG 200
Letti / Beds
Belloalto bed
Holden

PAG 202
*Complementi notte /
 Night accessories*
Isabey bedside table

PAG 203
Tappeti / Rugs
Amman
Lomé

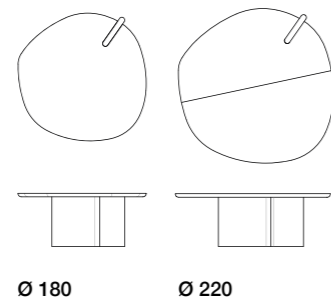

Ø 180

Ø 220

Ø 180 x h 75 cm - Ø 70,9" x h 29,5"
 Ø 220 x h 75 cm - Ø 86,6" x h 29,5"

FLATIRON TABLE ROUND TOP DESIGN MAURO LIPPARINI

Pag. 6-9
 Ø180 cm
 Piano e base in legno rovere spazzolato carbone
 Inserto in inox satinato

P. 6-9
 Ø180 cm
 Top and base in brushed coal oak
 Insert in brushed stainless steel

COMBINAZIONE 1

PIANO E BASE

Legno impiallacciato
 Rovere spazzolato Grey

INSERTO

Metallo
 Marrone
Metallo Special
 Inox satinato

COMBINAZIONE 2

PIANO E BASE

Legno impiallacciato
 Rovere spazzolato carbone

INSERTO

Metallo Plus
 Piombo
Metallo Special
 Inox satinato

COMBINATION 1

TOP AND BASE

Veneered wood
 Brushed Grey oak

INSERT

Metal
 Brown
Special metal
 Brushed stainless steel

COMBINATION 2

TOP AND BASE

Veneered wood
 Brushed coal oak

INSERT

Plus metal
 Lead
Special metal
 Brushed stainless steel

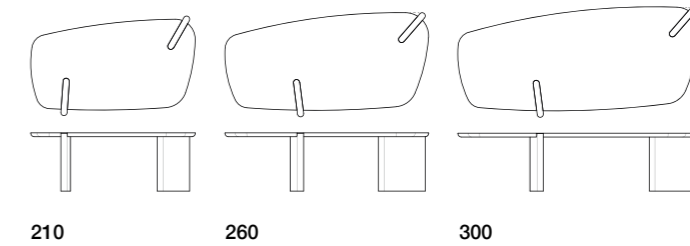

210

260

300

210 x 115 cm x h 75 cm - 82,7" x 45,3" x h 29,5"
 260 x 125 cm x h 75 cm - 102,4" x 49,2" x h 29,5"
 300 x 133 cm x h 75 cm - 118,1" x 52,4" x h 29,5"

FLATIRON TABLE DESIGN MAURO LIPPARINI

PIANO

Vetro fuso temperato
 Retro verniciato nero
Cristallo
 Glossy black

BORDO DEL PIANO
E BASE

Legno impiallacciato
 Rovere spazzolato carbone

INSERTO

Metallo Plus
 Piombo
Metallo Special
 Inox satinato

TOP

Tempered cast glass
 Back-painted black
Glass
 Glossy black

TOP'S EDGE
AND BASE

Veneered wood
 Brushed coal oak

INSERT

Plus metal
 Lead
Special metal
 Brushed stainless steel

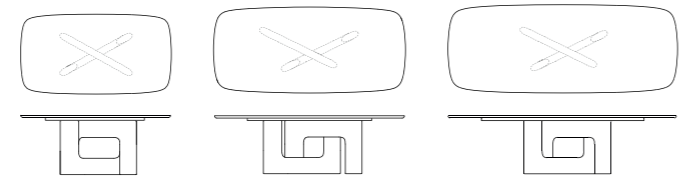

200 - 220

250

280 - 300

Altezza / Height

± h 75 cm / ± h 29,5"
L'altezza del tavolo varia a seconda del materiale scelto per il piano. Per maggiori informazioni e approfondimenti consultare il listino prezzi. / The height of the table could change depending on the material of the top. For more information check the price list.

200 x 108 cm x h. - 78,7" x 42,5" x h. 280 x 115 cm x h. - 110,2" x 45,3" x h.
220 x 110 cm x h. - 86,6" x 43,3" x h. 300 x 120 cm x h. - 118,1" x 47,2" x h.
250 x 112 cm x h. - 98,4" x 44,1" x h. 300 x 140 cm x h. - 118,1" x 55,1" x h.

LIAISON

DESIGN SPAZIOAMENO

Pag. 16-21
280x115 cm
Piano in marmo lucido Grigio Orobico
Base in dark nickel

P. 16-21
280x115 cm
Top in glossy Grigio Orobico marble
Dark nickel base

PIANO	TOP	200	220	250	280	300x120	300x140
Legno impiallacciato	Veneered wood						
Noce Canaletto	Canaletto walnut	•		•			•
Legno massello	Solid wood						
Noce Americano	American walnut	•		•			•
Rovere spazzolato carbone	Brushed coal oak	•		•			•
Rovere spazzolato Grey	Brushed Grey oak	•		•			•
Rovere spazzolato naturale	Brushed natural oak	•		•			•
Ceramica opaca	Mat ceramic						
Grigio Ardesia	Ardesia grey	•	•	•			•
Laurent	Laurent	•	•	•			•
Alaska White	Alaska White	•	•	•			•
Augusta	Augusta	•	•	•			•
Ceramica lucida	Glossy ceramic						
Calacatta	Calacatta	•	•	•			•
Calacatta Viola	Calacatta Viola	•	•	•			•
Black Onyx	Black Onyx	•	•	•			•
Imperial grey	Imperial grey	•	•	•			•
Mountain peak	Mountain peak	•	•	•			•
Rosso imperiale	Rosso imperiale	•	•	•			•
Ceramica finitura seta	Silk finish ceramic						
Calacatta Macchia Vecchia	Calacatta Macchia Vecchia	•	•	•			•
Daino Grigio	Daino Grigio	•	•	•			•
Marmo lucido o opaco	Glossy or mat marble						
Carrara	Carrara	•	•	•			•
Marquinia	Marquinia	•	•	•			•
Emperador	Emperador	•	•	•			•
Fior di Bosco	Fior di Bosco	•	•	•			•
Rosso Lepanto	Rosso Lepanto	•	•	•			•
Grigio Orobico	Grigio Orobico	•	•	•			•
Saint Denis	Saint Denis	•	•	•			•
Rosso Carpazi	Rosso Carpazi	•	•	•			•
Calacatta	Calacatta	•	•	•			•
Dover White	Dover White	•	•	•			•
Marmo opaco	Mat marble						
Travertino Romano	Travertino Romano	•	•	•			•
BASE	BASE						
Poliuretano ad alta densità	High density polyurethane						
Bronzo	Bronze						
Piombo	Lead						
Clouded Chrome	Clouded Chrome						
Brown nickel	Brown nickel						
Dark nickel	Dark nickel						
Glossy brown	Glossy brown						
Glossy grey	Glossy grey						



200 - 250 - 300

200 x 106 x h 75 cm - 78,7" x 41,7" x h 29,5"
250 x 115 x h 75 cm - 98,4" x 45,3" x h 29,5"
300 x 120 x h 75 cm - 118,1" x 47,2" x h 29,5"

OSHI

DESIGN GABRIELE E OSCAR BURATTI

Pag. 10-15
250x115 cm
Piano in ceramica Daino Grigio
Base in legno rovere brown

P. 10-15
250x115 cm
Top in Daino Grigio ceramic
Base in brown oak

PIANO	TOP
Cristallo	Glass
Glossy black	Glossy black
Ceramica opaca	Mat ceramic
Grigio Ardesia	Ardesia grey
Laurent	Laurent
Alaska White	Alaska White
Augusta	Augusta
Ceramica lucida	Glossy ceramic
Calacatta	Calacatta
Calacatta Viola	Calacatta Viola
Black Onyx	Black Onyx
Imperial grey	Imperial grey
Mountain peak	Mountain peak
Rosso imperiale	Rosso imperiale
Ceramica finitura seta	Silk finish ceramic
Calacatta Macchia Vecchia	Calacatta Macchia Vecchia
Daino Grigio	Daino Grigio
BASE	BASE
Legno massello	Solid wood
Rovere spazzolato brown	Brushed brown oak
Rovere spazzolato carbone	Brushed coal oak
Rovere spazzolato Grey	Brushed Grey oak

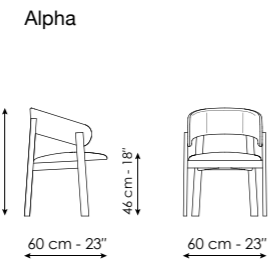

ALPHA

DESIGN GABRIELE
E OSCAR BURATTI

Pag. 24-27
Rivestimento in pelle Capri L53
Gambe in frassino brown

P. 24-27
Cover in L53 Capri leather
Legs in brown ash

IMBOTTITURA

Gomma indeformabile
ad alta densità

RIVESTIMENTO

Tessuto
Ecopelle
Pelle

Non sfoderabile

GAMBE

Legno massello
Noce Americano
Frassino carbone
Frassino grey
Frassino brown

PIEDE

Plastica con feltrino
sostituibile

PADDING

High density,
shrink-resistant foam

COVER

Fabric
Eco leather
Leather

Not removable

LEGS

Solid wood
American walnut
Coal ash
Grey ash
Brown ash

FEET

Plastic with replaceable
felt pad

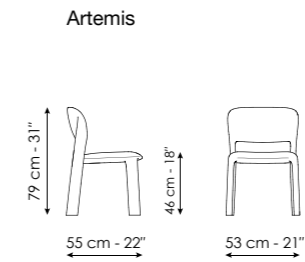

ARTEMIS

DESIGN MORITZ GRÜNDEL

Pag. 32-35
Rivestimento in tessuto MD01
-
P. 32-35
Cover in MD01 fabric

IMBOTTITURA

Poliuretano schiumato
a freddo

RIVESTIMENTO

Tessuto

Non sfoderabile

PIEDE

Plastica con feltrino
sostituibile

PADDING

Cold-foamed
polyurethane

COVER

Fabric

Not removable

FEET

Plastic with replaceable
felt pad

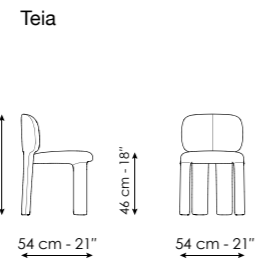

TEIA

DESIGN GINO CAROLLO

Pag. 28-31
Rivestimento in tessuto MD81
-
P. 28-31
Cover in MD81 fabric

IMBOTTITURA

Poliuretano schiumato
a freddo

RIVESTIMENTO

Tessuto
Ecopelle
Pelle

Non sfoderabile

PIEDE

Plastica con feltrino
sostituibile

PADDING

Cold-foamed
polyurethane

COVER

Fabric
Eco leather
Leather

Not removable

FEET

Plastic with replaceable
felt pad



ASPEN

DESIGN MASSIMO CASTAGNA

Pag. 38-43
Aspen 130
Piano in ceramica Daino Grigio
Base in dark nickel

Aspen 108
Piano in ceramica Daino Grigio
Base in dark nickel

-
P. 38-43
Aspen 130
Top in Daino Grigio ceramic
Dark nickel base

Aspen 108
Top in Daino Grigio ceramic
Dark nickel base

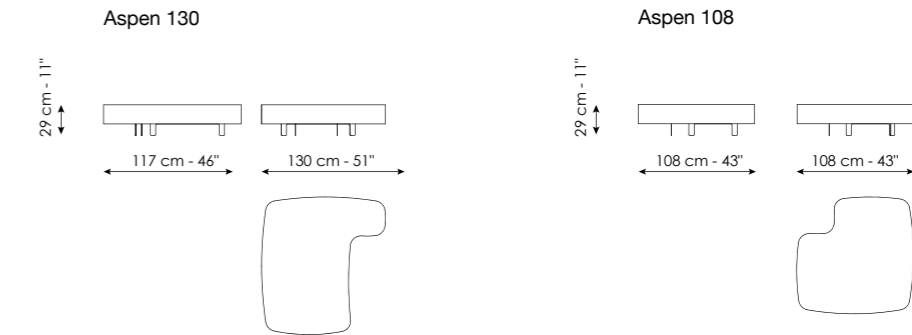

PIANO

Cristallo
Glossy brown
Glossy grey
Ceramica opaca
Grigio Ardesia
Laurent
Alaska White
Augusta
Ceramica lucida
Calacatta
Calacatta Viola
Black Onyx
Imperial grey
Mountain peak
Rosso imperiale
Ceramica finitura seta
Calacatta Macchia Vecchia
Daino Grigio

BASE

Metallo Plus
Bronzo
Piombo
Metallo Special
Clouded Chrome
Champagne nickel
Brown nickel
Dark nickel
Bright nickel

TOP

Glass
Glossy brown
Glossy grey
Mat ceramic
Ardesia grey
Laurent
Alaska White
Augusta
Glossy ceramic
Calacatta
Calacatta Viola
Black Onyx
Imperial grey
Mountain peak
Rosso imperiale
Silk finish ceramic
Calacatta Macchia Vecchia
Daino Grigio

BASE

Plus metal
Bronze
Lead
Special metal
Clouded Chrome
Champagne nickel
Brown nickel
Dark nickel
Bright nickel

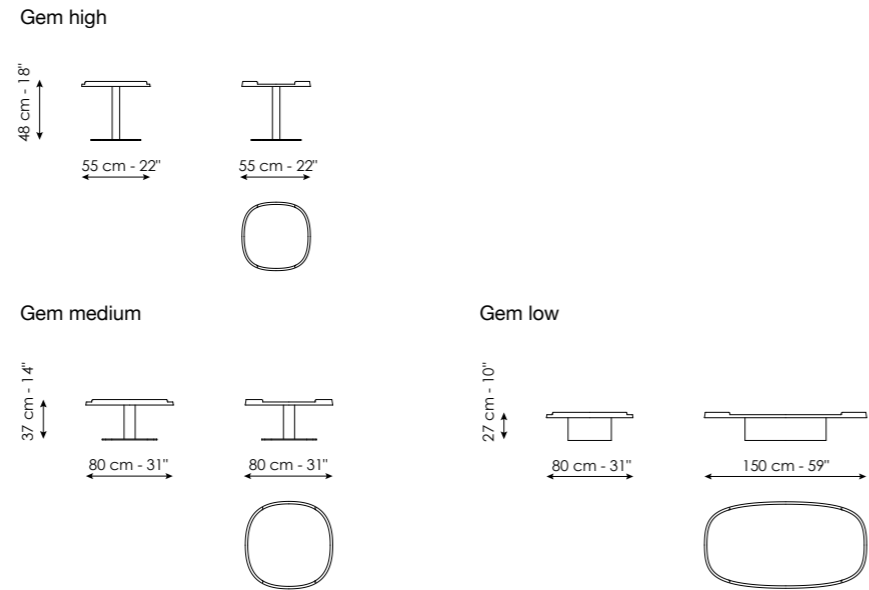

GEM
DESIGN MARCONATO & ZAPPA

Pag. 50-53
Gem high
Piano in ceramica Calacatta Viola
Bordo in legno laccato lucido glossy grey
Base piombo

Gem medium
Piano in ceramica Calacatta Viola
Bordo in legno laccato lucido glossy grey
Base piombo

Gem low
Piano in ceramica Calacatta Viola
Bordo in legno laccato lucido glossy grey
Base piombo

P. 50-53
Gem high
Top in Calacatta Viola ceramic
Edge in glossy grey lacquered wood
Lead base

Gem medium
Top in Calacatta Viola ceramic
Edge in glossy grey lacquered wood
Lead base

Gem low
Top in Calacatta Viola ceramic
Edge in glossy grey lacquered wood
Lead base

PIANO	TOP	HIGH	MEDIUM	LOW
Cristallo	Glass			
Glossy brown	Glossy brown	•	•	
Glossy grey	Glossy grey	•	•	
Ceramica opaca	Mat ceramic			
Grigio Ardesia	Ardesia grey	•	•	•
Laurent	Laurent	•	•	•
Alaska White	Alaska White	•	•	•
Augusta	Augusta	•	•	•
Ceramica lucida	Glossy ceramic			
Calacatta	Calacatta	•	•	•
Calacatta Viola	Calacatta Viola	•	•	•
Black Onyx	Black Onyx	•	•	•
Imperial grey	Imperial grey	•	•	•
Mountain peak	Mountain peak	•	•	•
Rosso imperiale	Rosso imperiale	•	•	•
Ceramica finitura seta	Silk finish ceramic			
Calacatta Macchia Vecchia	Calacatta Macchia Vecchia	•	•	•
Daino Grigio	Daino Grigio	•	•	•
OPZIONE BRONZO	BRONZE OPTION			
BORDO DEL PIANO	TOP EDGE			
Legno laccato lucido	Glossy lacquered wood			
Glossy brown	Glossy brown			
BASE	BASE			
Metallo Plus	Plus metal			
Bronzo	Bronze			
OPZIONE PIOMBO	LEAD OPTION			
BORDO DEL PIANO	TOP EDGE			
Legno laccato lucido	Glossy lacquered wood			
Glossy grey	Glossy grey			
BASE	BASE			
Metallo Plus	Plus metal			
Piombo	Lead			

SASSO
DESIGN GABRIELE
E OSCAR BURATTI

Pag. 44-47
Sasso high
Piano in cristallo glossy grey
Base piombo

Sasso medium
Piano in cristallo glossy grey
Base piombo

Sasso low
Piano in marmo lucido Grigio Orobico
Base piombo

P. 44-47
Sasso high
Top in glossy grey glass
Lead base

Sasso medium
Top in glossy grey glass
Lead base

Sasso low
Top in glossy Grigio Orobico marble
Lead base

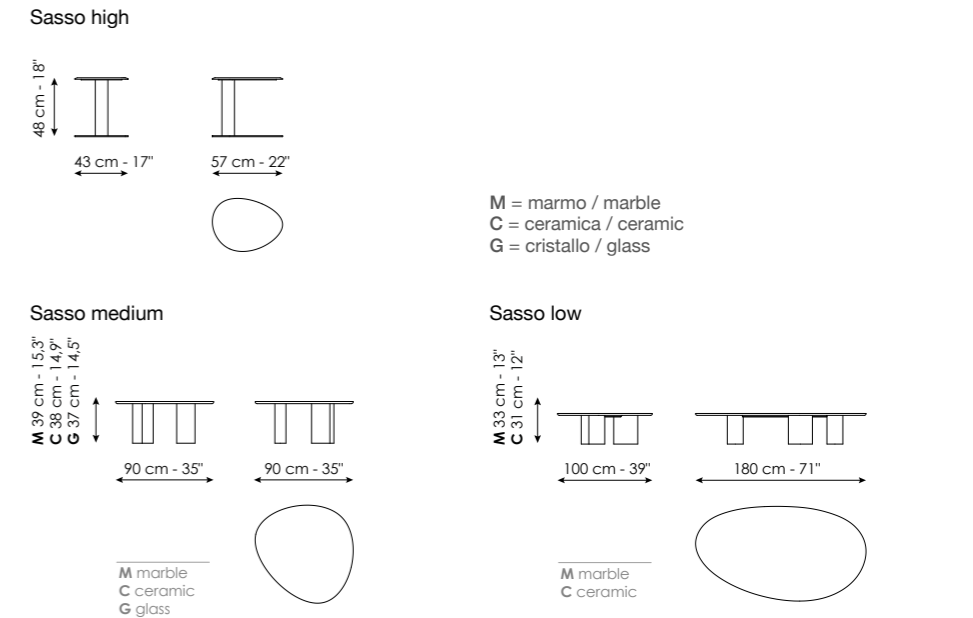

PIANO	TOP	HIGH	MEDIUM	LOW
Cristallo	Glass			
Glossy brown	Glossy brown	•	•	
Glossy grey	Glossy grey	•	•	
Legno finitura cemento	Concrete finish wood			
Mineral grey	Mineral grey	•	•	
Ceramica opaca	Mat ceramic			
Grigio Ardesia	Ardesia grey		•	•
Laurent	Laurent		•	•
Alaska White	Alaska White		•	•
Augusta	Augusta		•	•
Ceramica lucida	Glossy ceramic			
Calacatta	Calacatta		•	•
Calacatta Viola	Calacatta Viola		•	•
Black Onyx	Black Onyx		•	•
Imperial grey	Imperial grey		•	•
Mountain peak	Mountain peak		•	•
Rosso imperiale	Rosso imperiale		•	•
Ceramica finitura seta	Silk finish ceramic			
Calacatta Macchia Vecchia	Calacatta Macchia Vecchia		•	•
Daino Grigio	Daino Grigio		•	•
Marmo lucido o opaco	Glossy or mat marble			
Carrara	Carrara		•	•
Marquinia	Marquinia		•	•
Emperador	Emperador		•	•
Fior di Bosco	Fior di Bosco		•	•
Rosso Lepanto	Rosso Lepanto		•	•
Grigio Orobico	Grigio Orobico		•	•
Saint Denis	Saint Denis		•	•
Rosso Carpazi	Rosso Carpazi		•	•
Calacatta	Calacatta		•	•
Dover White	Dover White		•	•
Marmo opaco	Mat marble			
Travertino Romano	Travertino Romano		•	•
BASE	BASE			
Metallo Plus	Plus metal			
Bronzo	Bronze			
Piombo	Lead			
Metallo Special	Special metal			
Clouded Chrome	Clouded Chrome			
Champagne nickel	Champagne nickel			
Brown nickel	Brown nickel			
Dark nickel	Dark nickel			
Bright nickel	Bright nickel			



Sloan

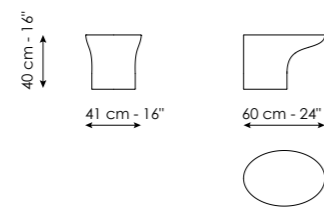

SLOAN

DESIGN MASSIMO CASTAGNA

STRUTTURA

Poliuretano ad alta densità
finitura cemento
Mineral white

FRAME

Concrete finish
high-density
polyurethane
Mineral white

Pag. 48-49
Struttura in finitura cemento mineral white
-
P. 48-49
Frame in mineral white concrete finish



ALICANTO

DESIGN GABRIELE
E OSCAR BURATTI

Pag. 60-63
Alicanto
Struttura e top in legno rovere brown

Pag. 64-65
Alicanto
Struttura in legno rovere brown
Top in ceramica Daino Grigio

-
P. 60-63
Alicanto
Frame and top in brown oak

P. 64-65
Alicanto
Frame in brown oak
Top in Daino Grigio ceramic

Alicanto

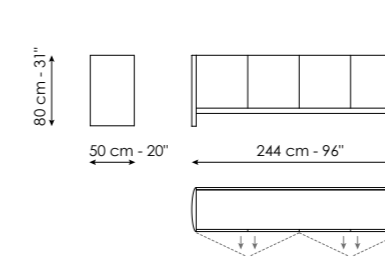

STRUTTURA

Legno impiallacciato
Rovere brown
Rovere carbone

TOP

Legno impiallacciato
Nella stessa finitura
della struttura
Ceramica opaca
Grigio Ardesia
Laurent
Alaska White
Augusta
Ceramica lucida
Calacatta
Calacatta Viola
Black Onyx
Imperial grey
Mountain peak
Rosso imperiale
Ceramica finitura seta
Calacatta Macchia Vecchia
Daino Grigio

STRUTTURA
INTERNA

Legno impiallacciato
Nella stessa finitura
della struttura

RIPIANI INTERNI

Cristallo
Trasparente

FRAME

Veneered wood
Brown oak
Coal oak

TOP

Veneered wood
In the same finish
as the frame
Mat ceramic
Ardesia grey
Laurent
Alaska White
Augusta
Glossy ceramic
Calacatta
Calacatta Viola
Black Onyx
Imperial grey
Mountain peak
Rosso imperiale
Silk finish ceramic
Calacatta Macchia Vecchia
Daino Grigio

INSIDE
FRAME

Veneered wood
In the same finish
as the frame

INSIDE SHELVES

Glass
Transparent

Alicanto midi

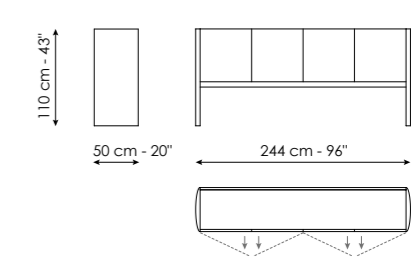

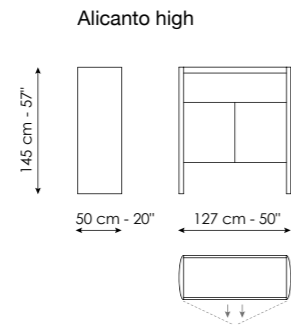

ALICANTO HIGH

DESIGN GABRIELE
E OSCAR BURATTI

Pag. 66-69
Struttura e top in legno
rovere carbone
-
P. 66-69
Frame and top in coal oak

STRUTTURA E VASSOIO SUPERIORE

Legno impiallacciato
Rovere brown
Rovere carbone

RIPIANO

Legno impiallacciato
Nella stessa finitura
della struttura

Ceramica opaca
Grigio Ardesia
Laurent
Alaska White
Augusta
Ceramica lucida
Calacatta
Calacatta Viola
Black Onyx
Imperial grey
Mountain peak
Rosso imperiale
Ceramica finitura seta
Calacatta Macchia Vecchia
Daino Grigio

STRUTTURA INTERNA

Legno impiallacciato
Nella stessa finitura
della struttura

RIPIANI INTERNI

Cristallo
Trasparente

FRAME AND UPPER TRAY

Veneered wood
Brown oak
Coal oak

SHELF

Veneered wood
In the same finish
as the frame

Mat ceramic
Ardesia grey
Laurent
Alaska White
Augusta
Glossy ceramic
Calacatta
Calacatta Viola
Black Onyx
Imperial grey
Mountain peak
Rosso imperiale
Silk finish ceramic
Calacatta Macchia Vecchia
Daino Grigio

INSIDE FRAME

Veneered wood
In the same finish
as the frame

INSIDE SHELVES

Glass
Transparent



BLOCCO SIDEBOARD

DESIGN ALAIN GILLES

Pag. 54-59
Blocco Sideboard low
Struttura e base in legno laccato
lucido glossy brown
-
P. 54-59
Blocco Sideboard low
Frame and base in glossy brown
lacquered wood

Blocco Sideboard

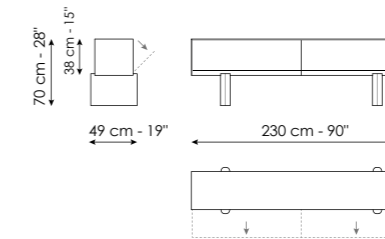

STRUTTURA

Legno laccato lucido
Glossy brown
Glossy grey

STRUTTURA INTERNA

Legno laccato opaco
In tinta con la struttura

FRAME

Glossy lacquered wood
Glossy brown
Glossy grey

INSIDE FRAME

Mat lacquered wood
In a color matching
the frame

Blocco Sideboard low

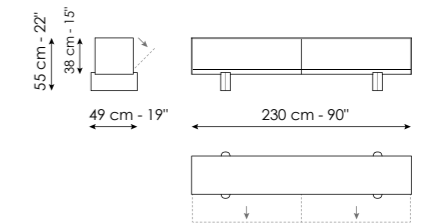



Spy

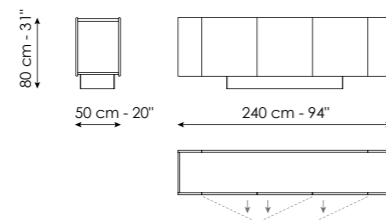

SPY

DESIGN MARCONATO & ZAPPA

Pag. 70-73
Struttura in legno laccato glossy grey
Top e fianchi in ceramica Mountain peak

Pag. 74-75
Struttura, top e fianchi in legno laccato glossy grey

P. 70-73
Frame in glossy grey lacquered wood
Top and side panels in Mountain peak ceramic

P. 74-75
Frame, top and side panels in glossy grey lacquered wood

STRUTTURA

Legno laccato lucido
Glossy brown
Glossy grey

RIPIANO LATERALE

Legno laccato opaco
In tinta con la struttura

TOP E FIANCHI LATERALI

Legno laccato lucido
Glossy brown
Glossy grey

Ceramica opaca
Grigio Ardesia
Laurent

Alaska White
Augusta

Ceramica lucida
Calacatta

Calacatta Viola
Black Onyx
Imperial grey
Mountain peak
Rosso imperiale

Ceramica finitura seta
Calacatta Macchia Vecchia
Daino Grigio

BASE A ZOCCOLO

Legno laccato opaco
In tinta con la struttura

STRUTTURA INTERNA

Legno laccato opaco
In tinta con la struttura

RIPIANI INTERNI

Cristallo
Trasparente

FRAME

Glossy lacquered wood
Glossy brown
Glossy grey

LATERAL SHELF

Mat lacquered wood
In a color matching the frame

TOP AND SIDE PANELS

Glossy lacquered wood
Glossy brown
Glossy grey

Mat ceramic
Ardesia grey
Laurent

Alaska White
Augusta

Glossy ceramic
Calacatta

Calacatta Viola
Black Onyx
Imperial grey
Mountain peak
Rosso imperiale

Silk finish ceramic
Calacatta Macchia Vecchia
Daino Grigio

PLINTH BASE

Mat lacquered wood
In a color matching the frame

INSIDE FRAME

Mat lacquered wood
In a color matching the frame

INSIDE SHELVES

Glass
Transparent



ARRAGAN SHELF

DESIGN GABRIELE
E OSCAR BURATTI

Pag. 76-79
Arragan shelf 180
Struttura in legno laccato lucido grigio vulcano
-
P. 76-79
Arragan shelf 180
Frame in volcano grey glossy lacquered wood

Arragan shelf 180

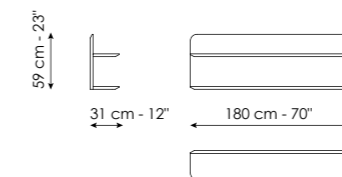

STRUTTURA

Legno laccato lucido o opaco
Grigio sabbia
Grigio vulcano

FRAME

Glossy or mat lacquered wood
Sandgrey
Volcano grey

Arragan shelf 120

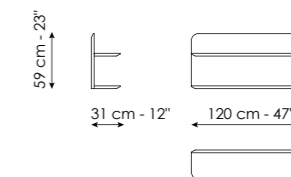



Arragan TV stand

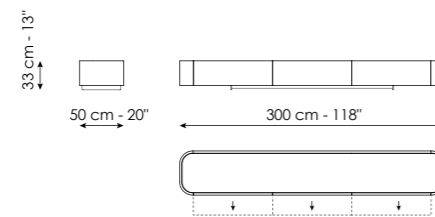

ARRAGAN TV STAND

DESIGN GABRIELE
E OSCAR BURATTI

Pag. 76-77, 79

Struttura in legno laccato
lucido grigio vulcano
Top in ceramica Calacatta
Macchia Vecchia
Piedi piombo

P. 76-77, 79

Arragan shelf 180
Frame in volcano grey glossy
lacquered wood
Top in Calacatta Macchia
Vecchia ceramic
Lead feet

STRUTTURA E CASSETTI

**Legno laccato lucido
o opaco**
Grigio sabbia
Grigio vulcano

TOP

Legno laccato opaco
In tinta con
la struttura
Ceramica opaca
Augusta
Ceramica lucida
Calacatta
Black Onyx
Mountain peak
Ceramica finitura seta
Calacatta Macchia Vecchia

PIEDI

Metallo Plus
Piombo

STRUTTURA INTERNA

Legno
Grigio scuro

FRAME AND DRAWERS

**Glossy or mat
lacquered wood**
Sandgrey
Volcano grey

TOP

Mat lacquered wood
In a color matching
the frame
Mat ceramic
Augusta
Glossy ceramic
Calacatta
Black Onyx
Mountain peak
Silk finish ceramic
Calacatta Macchia Vecchia

FEET

Plus metal
Lead

INSIDE FRAME

Wood
Dark grey



BLOCCO DESK

DESIGN ALAIN GILLES

Pag. 80-85

Struttura in legno noce Canaletto

-

P. 80-85

Frame in Canaletto walnut

Blocco Desk

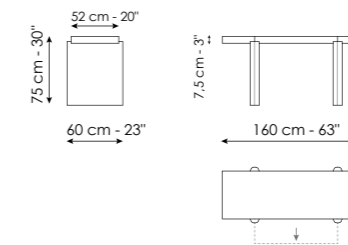

STRUTTURA

Legno impiallacciato
Noce Canaletto

FRAME

Veneered wood
Canaletto walnut



Isabey desk

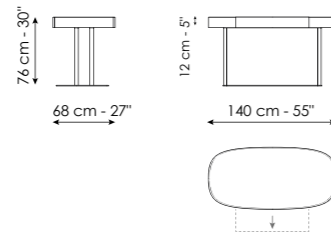

ISABEY DESK

DESIGN GABRIELE
E OSCAR BURATTI

Pag. 86-89
Struttura in legno rovere brown
Base piombo
-
P. 86-89
Frame in brown oak
Lead base

PIANO

Legno impiallacciato

Noce Canaletto
Rovere brown
Rovere carbone
Rovere grey

BASE

Metallo Plus

Bronzo
Piombo
Metallo Special
Clouded Chrome
Brown nickel
Dark nickel
Champagne nickel
Bright nickel

TOP

Veneered wood

Canaletto walnut
Brown oak
Coal oak
Grey ash

BASE

Plus metal

Bronze
Lead
Special metal
Clouded Chrome
Brown nickel
Dark nickel
Champagne nickel
Bright nickel



MISTRAL

DESIGN MARCONATO & ZAPPA

Pag. 90-91
Cornice in poliuretano glossy grey
Piede piombo
-
P. 90-91
Frame in glossy grey polyurethane
Lead feet

Mistral

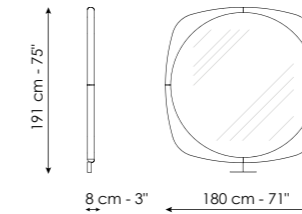

CORNICE

Poliuretano ad alta densità Plus

Bronzo
Piombo
Poliuretano ad alta densità Special
Glossy brown
Glossy grey

PIEDE

Metallo Plus
Bronzo
Piombo
Metallo Special
Clouded Chrome
Brown nickel
Dark nickel
Champagne nickel
Bright nickel

FRAME

Plus high density polyurethane

Bronze
Lead
Special high density polyurethane
Glossy brown
Glossy grey

FEET

Plus metal
Bronze
Lead
Special metal
Clouded Chrome
Brown nickel
Dark nickel
Champagne nickel
Bright nickel



ALDEBARAN
DESIGN GABRIELE
E OSCAR BURATTI

- | | |
|-------------------------------------|--|
| RIVESTIMENTO | COVER |
| Tessuto | Fabric |
| Pelle | Leather |
| <i>Sfoderabile (no pelle)</i> | <i>Removable (no leather)</i> |
| PIEDI | FEET |
| Metallo | Metal |
| Nero | Black |
| IMBOTTITURA | PADDING |
| Poliuretano espanso a varie densità | Polyurethane foam padding with various densities |

Terminale dx/sx
End section sofa right/left

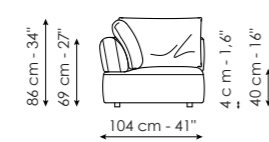

180

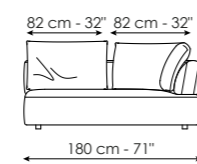

150

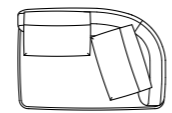
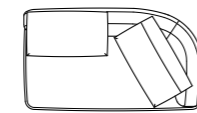
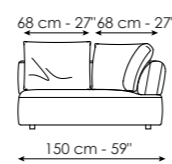

Penisola dx/sx
Penisola right/left

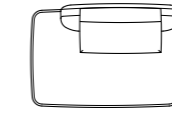
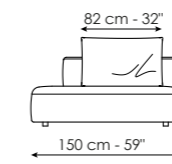
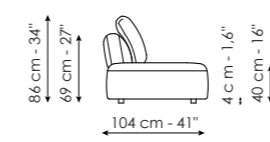

Penisola curva dx/sx
Curved peninsula right/left

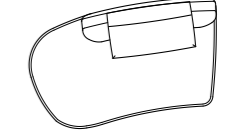
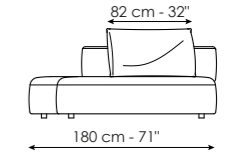
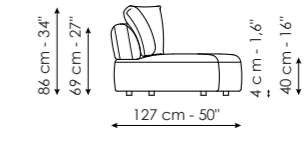

Centrale
Center section

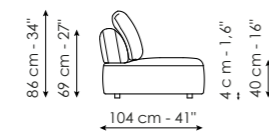

180

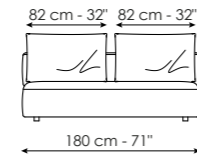

150

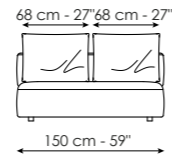

120

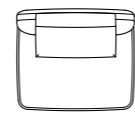
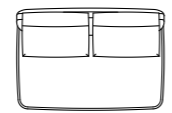
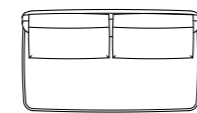
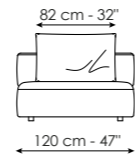

Angolo
Corner

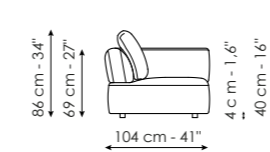

Angolo curva
Curved corner

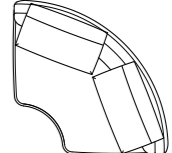
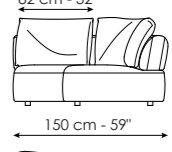
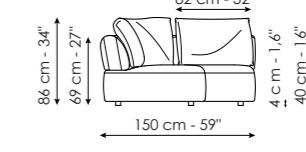

Terminale curvo dx/sx
Curved end section sofa right/left

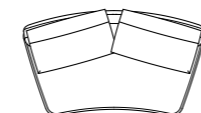
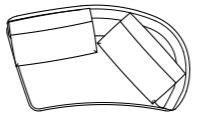
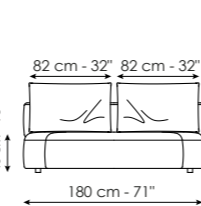
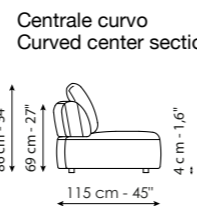
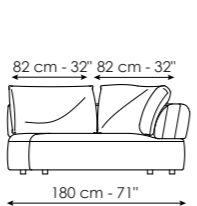
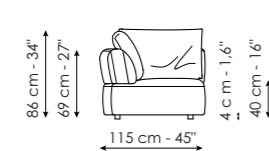

Pouf

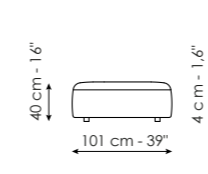

150 x 101

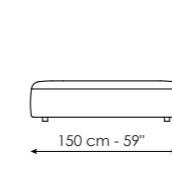

120 x 101

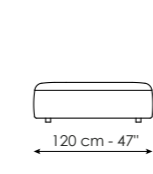

101 x 101

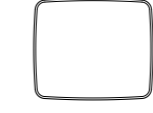
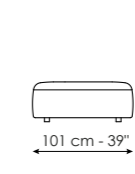

Pouf curvo
Curved pouf

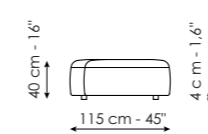

180 x 101

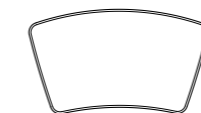
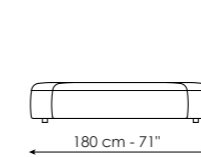



ALDEBARAN
DESIGN GABRIELE
E OSCAR BURATTI

 Pag. 94-103
Rivestimento in tessuto ME25
Piedi neri
-
P. 94-103
Cover in ME25 fabric
Black feet

Composizione 1 / Composition 1 

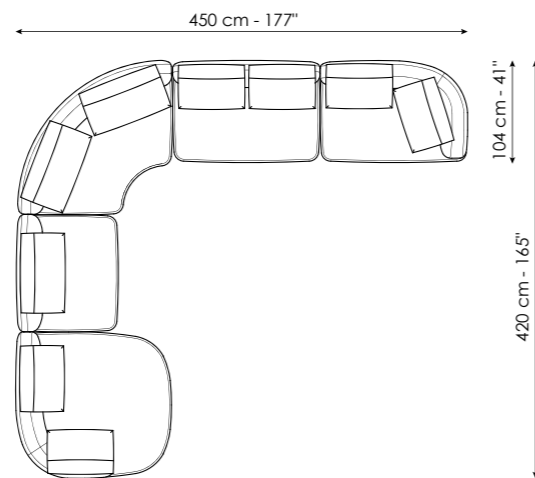

Composizione 2 / Composition 2

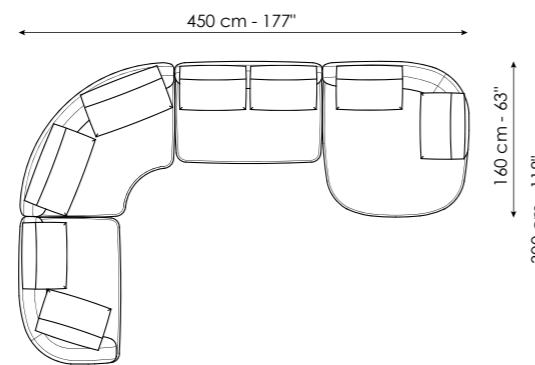

Composizione 3 / Composition 3 

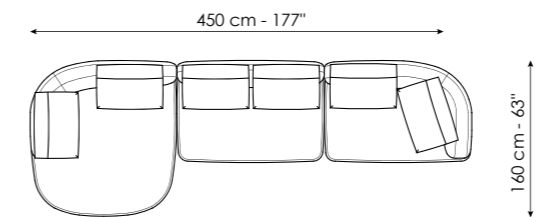

Composizione 5 / Composition 5

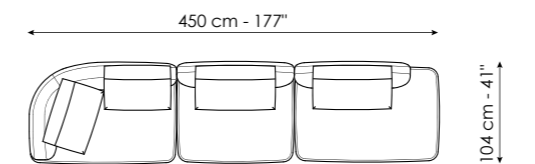

Composizione 4 / Composition 4

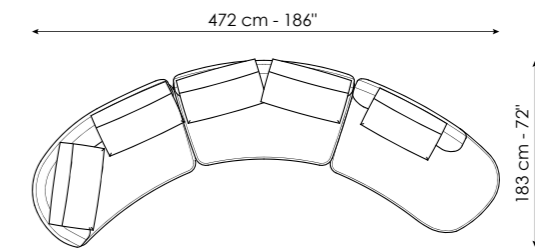

Composizione 6 / Composition 6

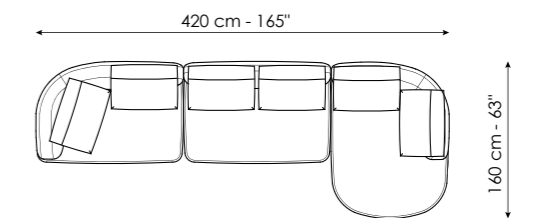



BELLOALTO
DESIGN GABRIELE
E OSCAR BURATTI

- | | |
|-------------------------------------|--|
| RIVESTIMENTO | COVER |
| Tessuto | Fabric |
| Pelle | Leather |
| Sfoderabile (no pelle) | Removable (no leather) |
| PIEDI | FEET |
| Metallo | Metal |
| Nero | Black |
| IMBOTTITURA | PADDING |
| Poliuretano espanso a varie densità | Polyurethane foam padding with various densities |

Terminale dx/sx
End section sofa right/left

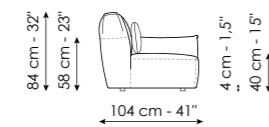

150

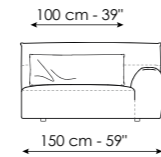

135

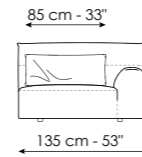

120

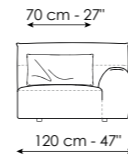

Penisola dx/sx
Penisola right/left

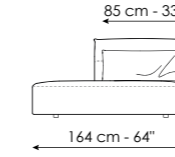
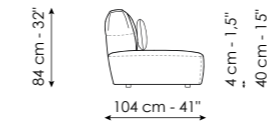

Angolo
Corner

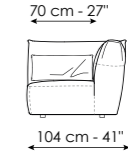
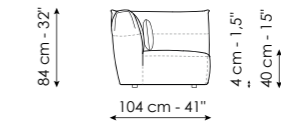

Centrale
Center section

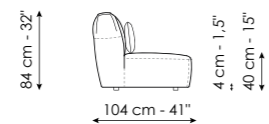

120

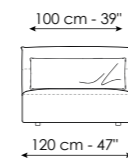

104
NEW

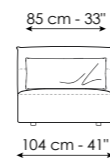

Terminale hi dx/sx
End section sofa hi right/left

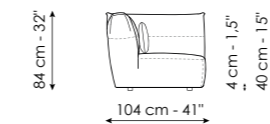

135

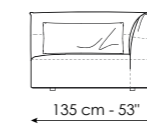

120

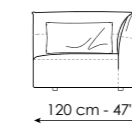

Chaise longue dx/sx
Chaise longue right/left

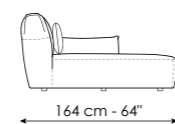
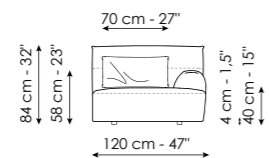

Chaise longue inclinata dx/sx
Angled chaise longue right/left

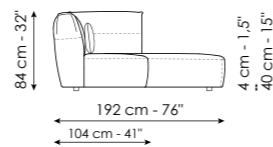

NEW

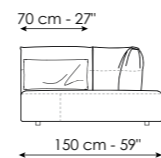

Pouf

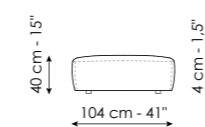

120 x 104
NEW

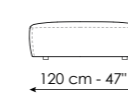

104 x 104

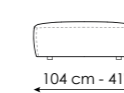

80 x 104

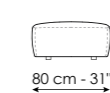



BELLOALTO
DESIGN GABRIELE
E OSCAR BURATTI

 Pag. 120-125
Rivestimento in tessuto ME10
Piedi neri
-
P. 120-125
Cover in ME10 fabric
Black feet

Composizione 1 / Composition 1

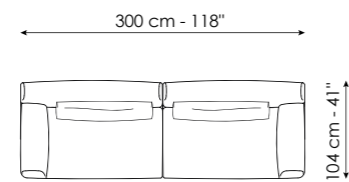

Composizione 2 / Composition 2

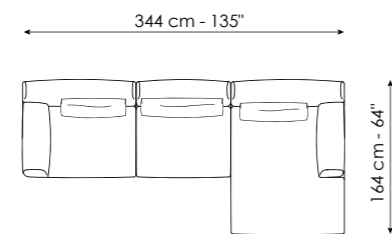

Composizione 3 / Composition 3 
NEW

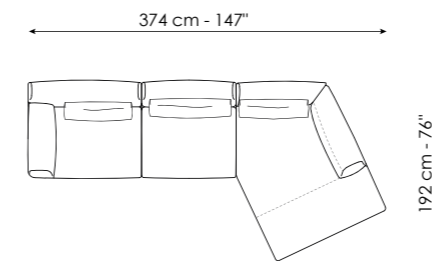

Composizione 5 / Composition 5
NEW

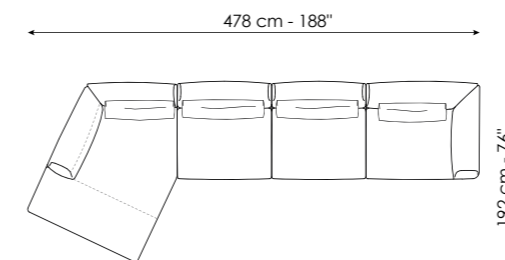

Composizione 4 / Composition 4

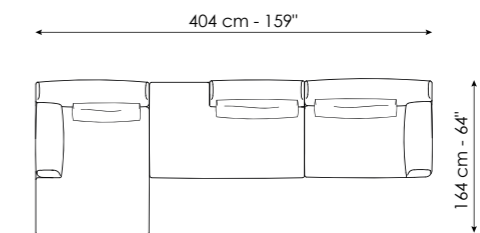

Composizione 6 / Composition 6

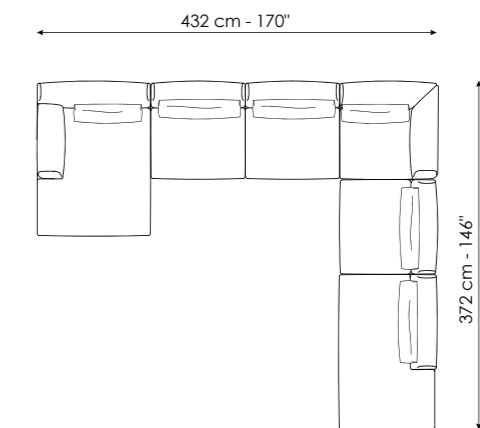



GRANT
DESIGN MASSIMO CASTAGNA

RIVESTIMENTO COVER
Tessuto Fabric
Pelle Leather
Sfoderabile (no pelle) Removable (no leather)

PIEDI FEET
Metallo Metal
Bianco White
Nero Black
Tortora Dove grey
Supreme anthracite Supreme anthracite
Metallo Plus Plus metal
Bronzo Bronze
Oro perlato Pearl gold
Piombo Lead
Metallo Special Special metal
Clouded Chrome Clouded Chrome
Champagne nickel Champagne nickel
Brown nickel Brown nickel
Dark nickel Dark nickel
Bright nickel Bright nickel

IMBOTTITURA PADDING
Poliuretano espanso a varie densità Polyurethane foam padding with various densities

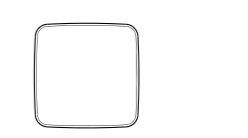
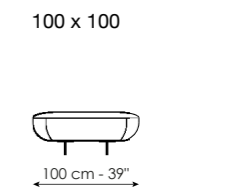
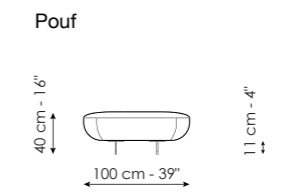
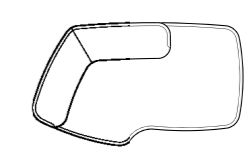
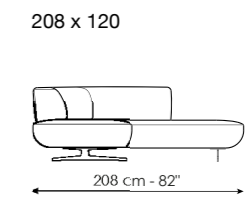
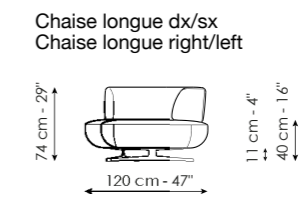
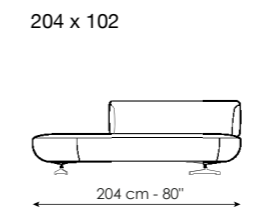
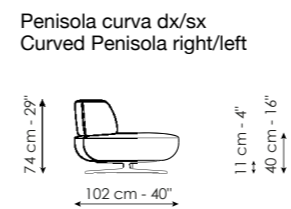
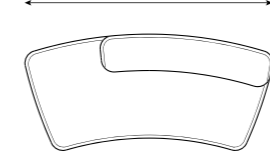
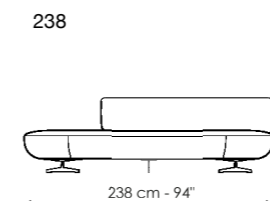
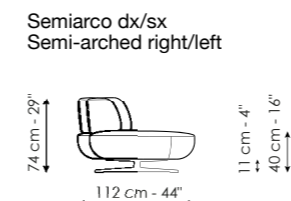
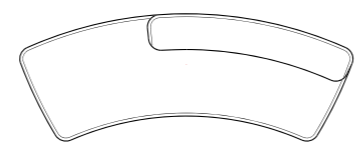
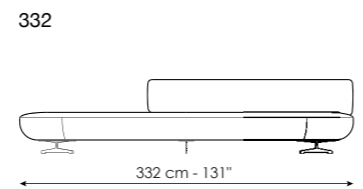
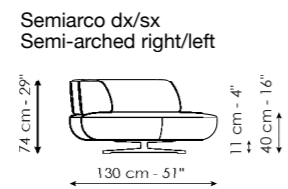
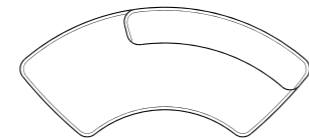
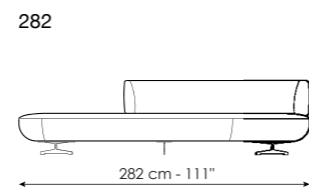
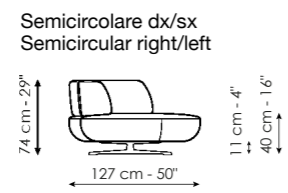
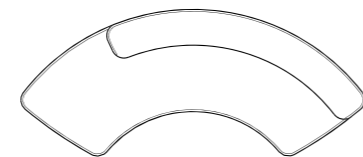
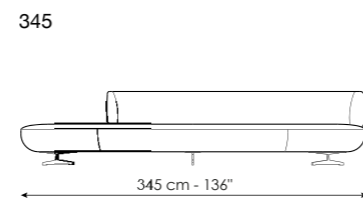
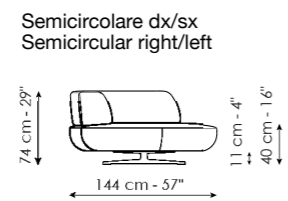





GRANT
DESIGN MASSIMO CASTAGNA

 Pag. 104-119
Rivestimento in tessuto 9B73
Base in champagne nickel
-
P. 104-119
Cover in 9B73 fabric
Champagne nickel base

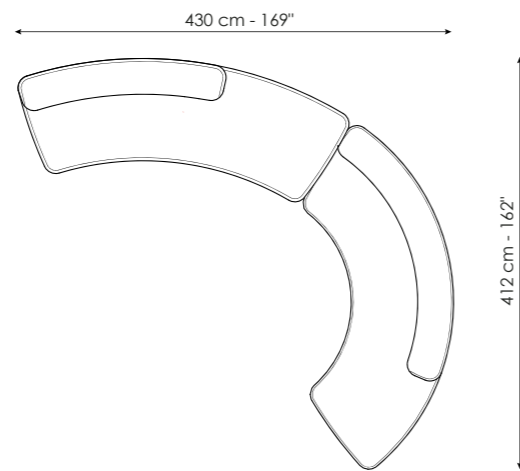
Composizione 1 / Composition 1



Composizione 2 / Composition 2 

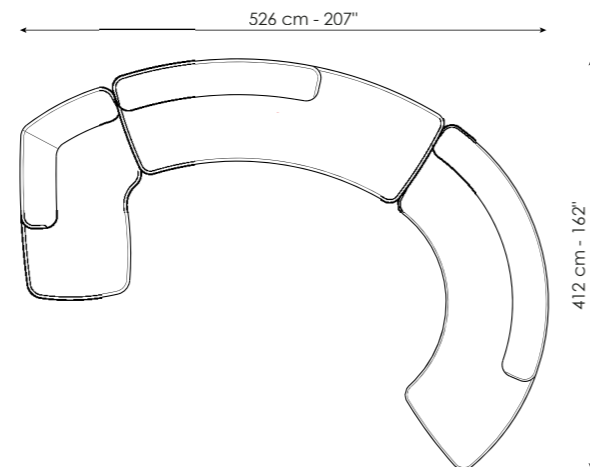

Composizione 3 / Composition 3 

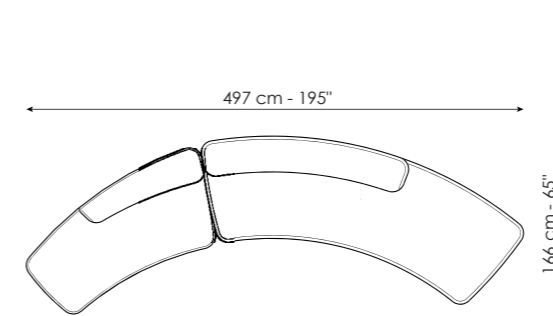

Composizione 4 / Composition 4

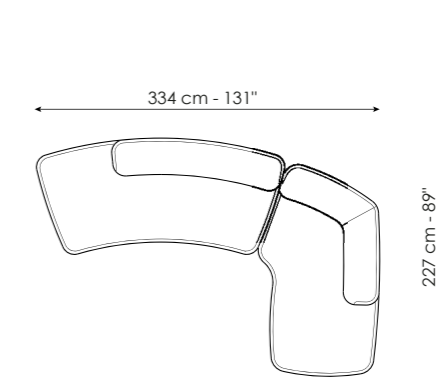

Composizione 5 / Composition 5 

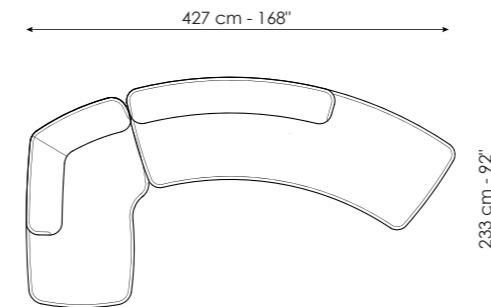

Composizione 6 / Composition 6

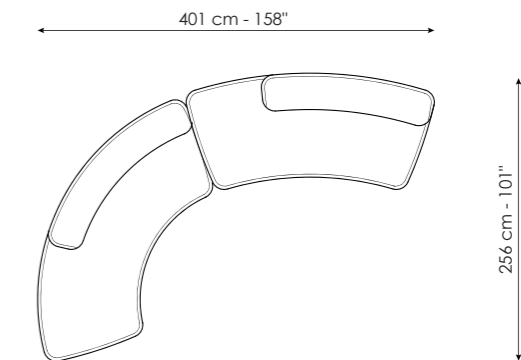

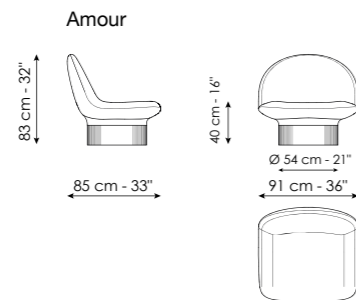

AMOUR

DESIGN FABRICE BERRUX

Pag. 128-133
Rivestimento in pelle Panarea C05
Base girevole in champagne nickel

P. 128-133
Cover in C05 Panarea leather
Champagne nickel swivel base

RIVESTIMENTO

Tessuto
Ecopelle
Pelle

Non sfoderabile

BASE

Metallo
Bianco
Nero
Tortora
Supreme anthracite
Metallo Plus
Bronzo
Oro perlato
Piombo
Ottone opaco
Rame opaco
Metallo Special
Clouded Chrome
Champagne nickel
Brown nickel
Dark nickel
Bright nickel

IMBOTTITURA

Poliuretano
schiumato a freddo

COVER

Fabric
Eco leather
Leather

Not removable

BASE

Metal
White
Black
Dove grey
Supreme anthracite
Plus metal
Bronze
Pearl gold
Lead
Mat brass
Mat copper
Special metal
Clouded Chrome
Champagne nickel
Brown nickel
Dark nickel
Bright nickel

PADDING

Cold-foamed
polyurethane

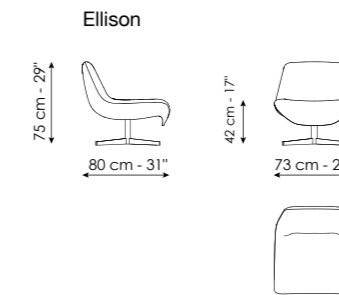

ELLISON

DESIGN MASSIMO CASTAGNA

Pag. 134-137
Rivestimento in pelle Panarea C02
Base girevole in champagne nickel

P. 134-137
Cover in C02 Panarea leather
Champagne nickel swivel base

RIVESTIMENTO

Tessuto
Ecopelle
Pelle

Non sfoderabile

BASE

Metallo
Bianco
Nero
Tortora
Supreme anthracite
Metallo Plus
Bronzo
Oro perlato
Piombo
Ottone opaco
Rame opaco
Metallo Special
Clouded Chrome
Champagne nickel
Brown nickel
Dark nickel
Bright nickel

IMBOTTITURA

Poliuretano
schiumato a freddo

COVER

Fabric
Eco leather
Leather

Not removable

BASE

Metal
White
Black
Dove grey
Supreme anthracite
Plus metal
Bronze
Pearl gold
Lead
Mat brass
Mat copper
Special metal
Clouded Chrome
Champagne nickel
Brown nickel
Dark nickel
Bright nickel

PADDING

Cold-foamed
polyurethane

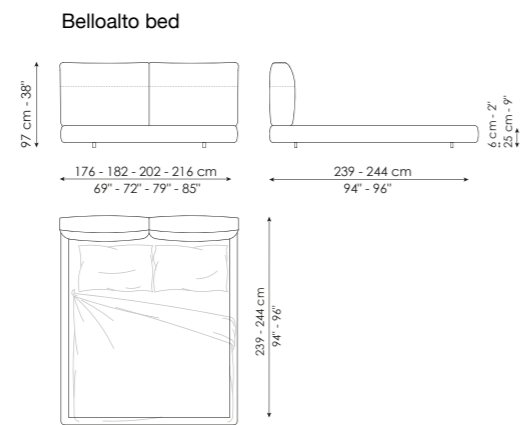

BELLOALTO BED

DESIGN GABRIELE
E OSCAR BURATTI

Pag. 146-151
Rivestimento in tessuto 9B73
Piedi neri

P. 146-151
Cover in 9B73 fabric
Black feet

RIVESTIMENTO

Tessuto
Pelle

Sfoderabile (no pelle)

PIEDE

Metallo
Nero

IMBOTTITURA

Poliuretano espanso
a varie densità

COVER

Fabric
Leather

Removable (no leather)

FEET

Metal
Black

PADDING

Polyurethane foam padding
with various densities

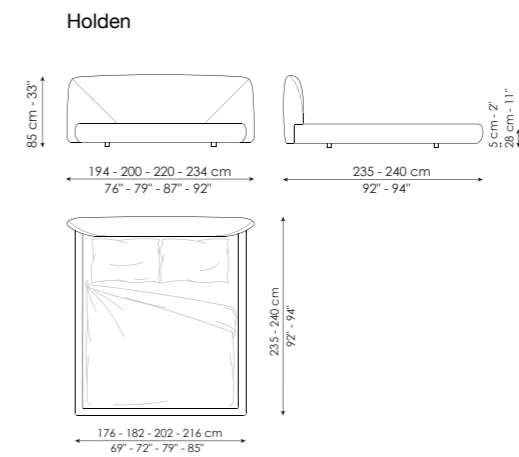

HOLDEN

DESIGN MASSIMO CASTAGNA

Pag. 140-145
Rivestimento in pelle Panarea C11
Piedi neri

P. 140-145
Cover in C11 Panarea leather
Black feet

RIVESTIMENTO

Tessuto
Ecopelle
Pelle

Sfoderabile (no pelle)

PIEDE

Metallo
Nero

IMBOTTITURA

Poliuretano
espanso sagomato

COVER

Fabric
Eco leather
Leather

Removable (no leather)

FEET

Metal
Black

PADDING

Shaped polyurethane
foam



Isabey bedside table
1 cassetto / 1 drawer

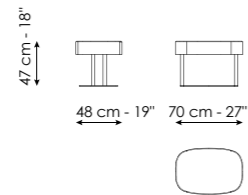

Isabey bedside table
2 cassetti / 2 drawers

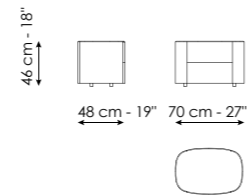

ISABEY BEDSIDE TABLE DESIGN GABRIELE E OSCAR BURATTI

Pag. 154-155
Comodino con 1 cassetto
Struttura in legno noce Canaletto
Base bronzo

Pag. 152-153
Comodino con 2 cassetti
Struttura in legno noce Canaletto

P. 154-155
Bedside table with 1 drawer
Frame in Canaletto walnut
Bronze base

P. 152-153
Bedside table with 2 drawers
Frame in Canaletto walnut

COMODINO CON 1 CASSETTO

STRUTTURA

Legno impiallacciato
Noce Canaletto
Rovere brown
Rovere carbone

BASE

Metallo Plus
Bronzo
Piombo
Metallo Special
Clouded Chrome
Champagne nickel
Brown nickel
Dark nickel
Bright nickel

BEDSIDE TABLE WITH 1 DRAWER

FRAME

Veneered wood
Canaletto walnut
Brown oak
Coal oak

BASE

Plus metal
Bronze
Lead
Special metal
Clouded Chrome
Champagne nickel
Brown nickel
Dark nickel
Bright nickel

COMODINO CON 2 CASSETTI

STRUTTURA

Legno impiallacciato
Noce Canaletto
Rovere brown
Rovere carbone

BASE

Plastica
Nero

BEDSIDE TABLE WITH 2 DRAWERS

FRAME

Veneered wood
Canaletto walnut
Brown oak
Coal oak

BASE

Plastic
Black

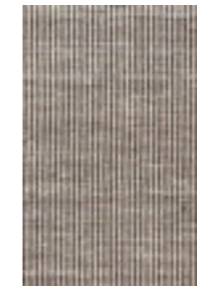

AMMAN

Pag. 158-159
Amman 400x300 cm
Avorio - Marrone
-
P. 158-159
Amman 400x300 cm
Ivory - Brown

Amman 400 x 300

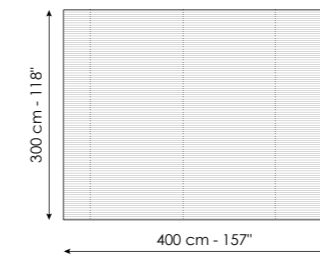

Amman 200 x 300

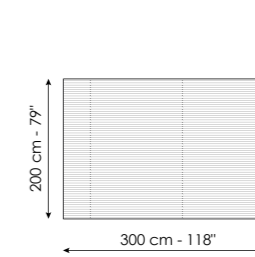

COMPOSIZIONE

80% Juta
20% Cotone

Tappeto realizzato
con la tecnica della
tessitura a mano

COLORI

Avorio - Marrone

COMPOSITION

80% Juta
20% Cotton

Rug made using
the hand-woven
technique

COLORS

Ivory - Brown

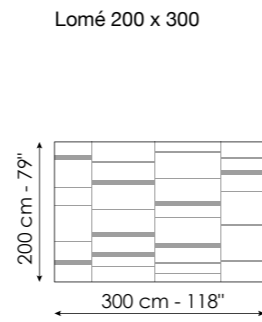
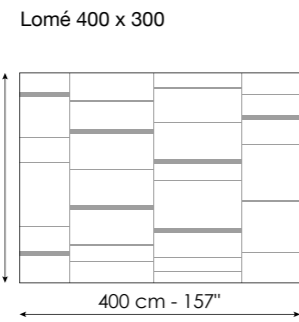

LOMÉ

COMPOSIZIONE

100% Lana

Tappeto realizzato con la tecnica della tessitura a mano

COLORI

Bianco - Marrone

COMPOSITION

100% Lana

Rug made using the hand-woven technique

COLORS

White - Brown

Pag. 160-163
Lomé 400x300 cm
Bianco - Marrone

P. 160-163
Lomé 400x300 cm
White - Brown

MARMO LUCIDO OD OPACO / GLOSSY OR MAT MARBLE

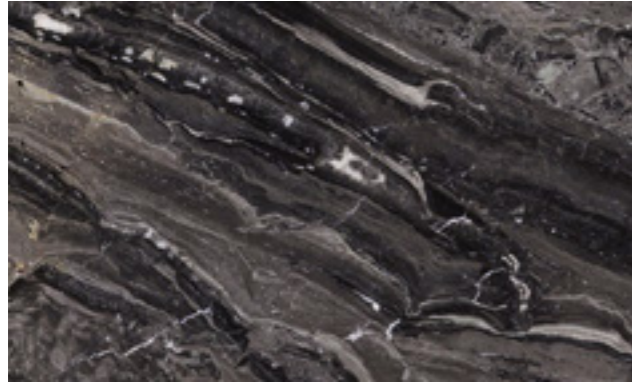

Grigio Orobico

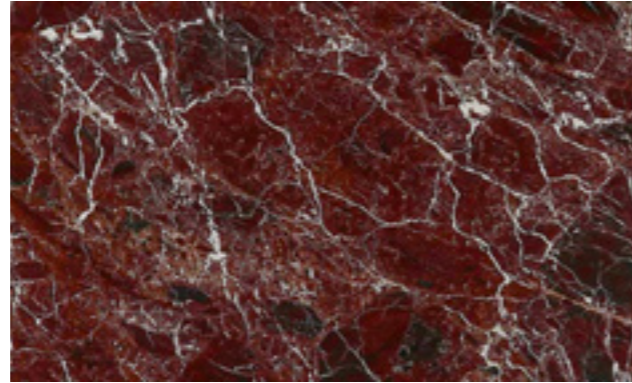

Rosso Lepanto

CERAMICA LUCIDA / GLOSSY CERAMIC

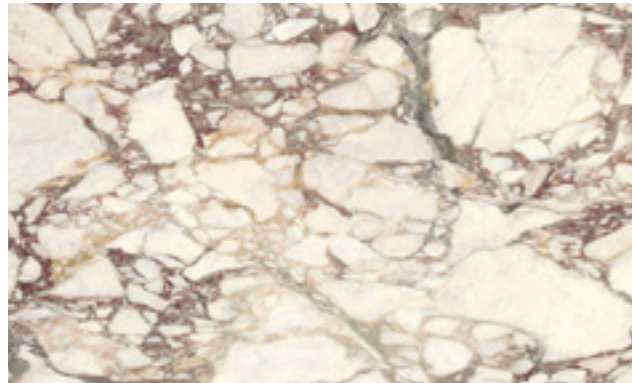

Calacatta Viola

CERAMICA FINITURA SETA / SILK FINISH CERAMIC



Daino Grigio

LEGNO / WOOD



Rovere brown / Brown oak



Frassino brown / Brown ash

LEGNO LACCATO LUCIDO / GLOSSY LACQUERED WOOD



Glossy grey

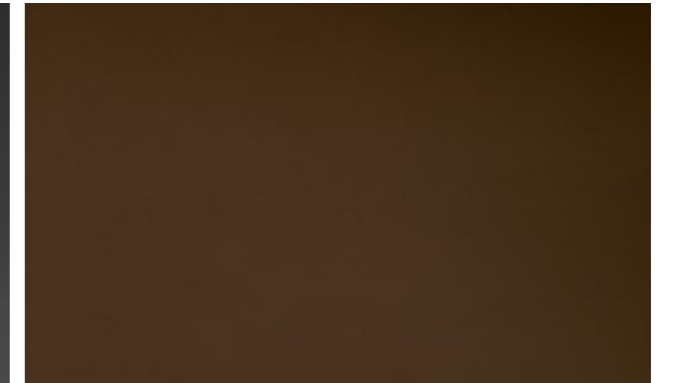

Glossy brown

POLIURETANO AD ALTA DENSITÀ SPECIAL / SPECIAL HIGH DENSITY POLYURETHANE



Glossy grey

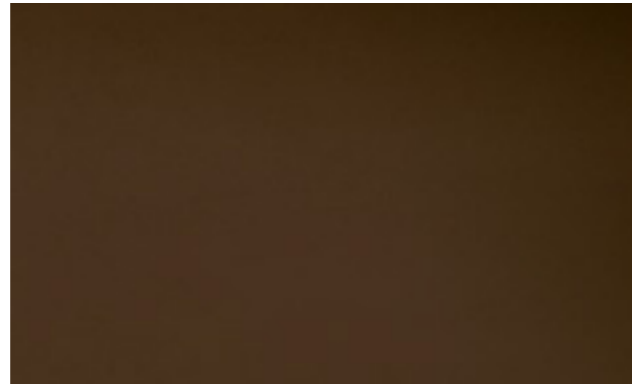

Glossy brown

CRISTALLO / GLASS



Glossy grey

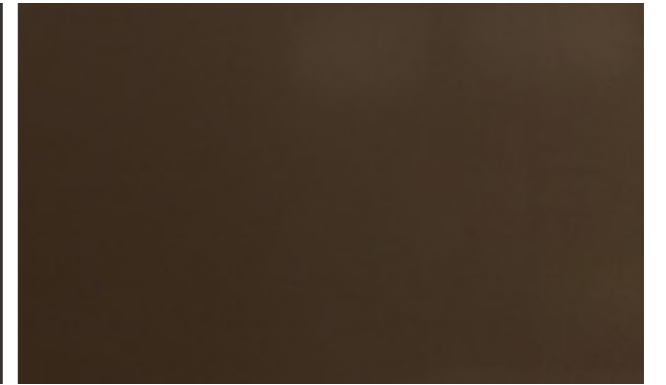

Glossy brown

FINITURA CEMENTO / CONCRETE FINISH

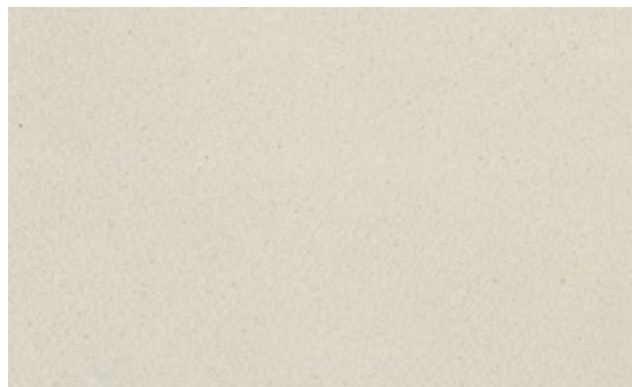

Mineral white

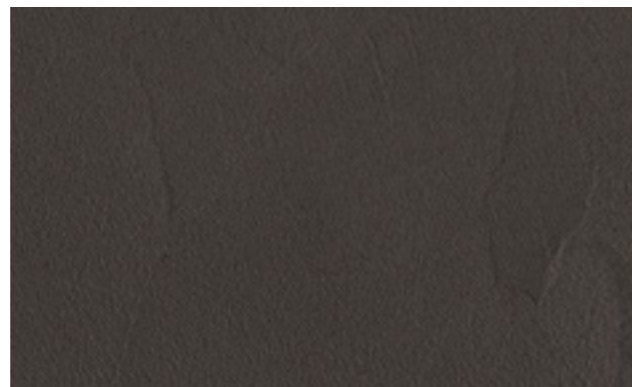

Mineral grey

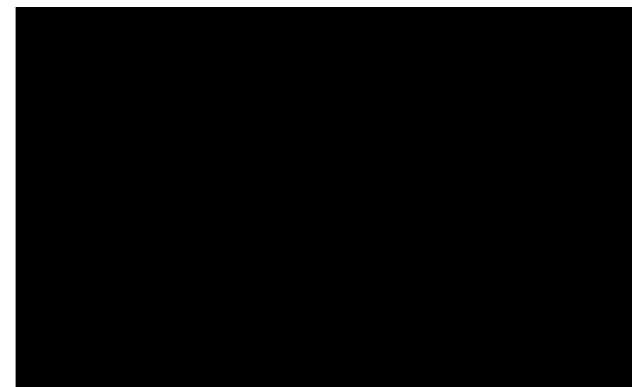

Glossy black

METALLO SPECIAL / SPECIAL METAL

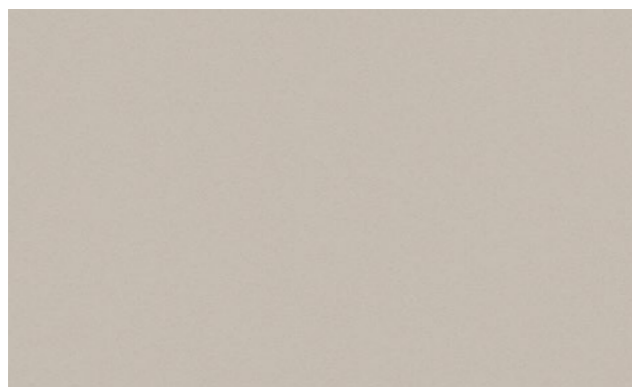

Champagne nickel

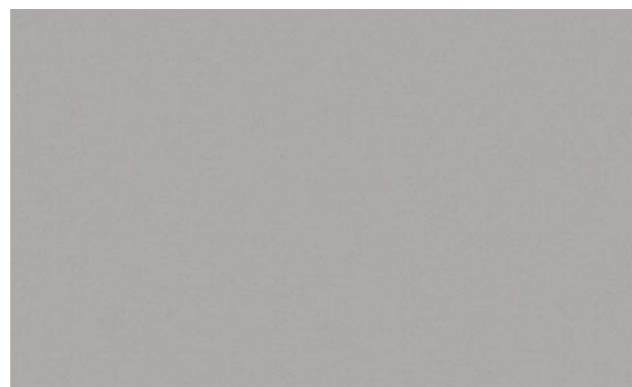

Bright nickel

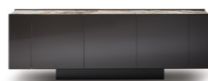
Tavoli / TablesFlatiron table round top
pag. 6-9Liaison
pag. 16-21Oshi
pag. 10-15**Sedie / Chairs**Alpha
pag. 24-27Artemis
pag. 32-35Teia
pag. 28-31**Tavolini / Coffee Tables**Aspen
pag. 38-43Gem
pag. 50-53Sasso
pag. 44-47Sloan
pag. 48-49**Credenze / Sideboards**Alicanto
pag. 60-65Alicanto high
pag. 66-69Blocco Sideboard
pag. 54-59Spy
pag. 70-75**Scrivani / Home office**Blocco Desk
pag. 80-85Isabey desk
pag. 86-89**Specchi / Mirrors**Mistral
pag. 90-91**Porta TV / TV Stands**Arragan TV stand
pag. 76-79**Librerie / Bookshelves**Arragan shelf
pag. 76-79**Divani / Sofas**Aldebaran
pag. 94-103Belloalto
pag. 120-125Grant
pag. 104-119**Poltrone / Armchairs**Amour
pag. 128-133Ellison
pag. 134-137**Letti / Beds**Belloalto bed
pag. 146-151Holden
pag. 140-145**Complementi notte / Night accessories**Isabey bedside table
pag. 152-155**Tappeti / Rugs**Amman
pag. 158-159Lomé
pag. 160-163

Concept
Bonaldo SpA

Graphic design
romanoassociati.com

Photographer
Federico Cedrone

Styling
Candida Zanelli
Rosaria Sofia Galli

Thanks to
FISCHBACHER1819

Pre-press and printing
Grafiche Antiga



Printed in Italy
April 2026

Bonaldo SpA si riserva il diritto di modificare, senza preavviso, materiali, rivestimenti, finiture e disegni dei prodotti presentati in questo catalogo. I colori e le finiture visualizzate sono puramente indicativi e possono differire dagli originali. Le immagini riprodotte nel presente catalogo sono di proprietà esclusiva di Bonaldo SpA. È vietata qualunque riproduzione o utilizzo delle immagini senza preventiva autorizzazione scritta di Bonaldo SpA.

Bonaldo SpA reserves the right to change, without any notice, materials, covers, finishes and drawings of the products of this catalogue. Colors and finishes shown are approximate and may differ from actual ones. All images in this catalogue are property of Bonaldo SpA. Every reproduction or use of the images without prior written authorization from Bonaldo SpA is therefore strictly forbidden.



www.bonaldo.com



Follow Bonaldo on WeChat

BONALDO

Bonaldo SpA a socio unico
via Straelle 3, 35010 Villanova di Camposampiero (PD) Italy tel + 39 049.9299011
info@bonaldo.com www.bonaldo.com



